

EURASIA

HOTEL | CHIANG MAI

EURASIA

HOTEL | CHIANG MAI



- | | |
|-------------------|---|
| Mae Hong Son | 1. The Imperial Mae Hong Son Resort |
| Chiang Rai | 2. The Imperial Golden Triangle Resort 3. The Imperial River House Resort |
| Chiang Mai | 4. The Imperial Resort & Sports Club Chiang Mai 5. Imm Hotel Thaphae Chiang Mai 6. CH Hotel 7. Eco Resort Chiang Mai 8. Eurasia Chiang Mai Hotel 9. Night Bazaar Place |
| Phitsanulok | 10. The Imperial Hotel and Convention Centre Phitsanulok |
| Petchabun | 11. The Imperial Phukaew Hill Resort |
| Nakhon Ratchasima | 12. The Imperial Hotel and Convention Centre Korat |
| Bangkok | 13. The Raweekanlaya Bangkok Wellness Cuisine Resort 14. The Pantip Hotel Ladprao Bangkok 15. The Tarntawan Hotel Surawong Bangkok |
| Cha-am | 16. Eurasia Resort Cha-am |
| Narathiwat | 17. The Imperial Narathiwat Hotel |



EXPLORE CHIANG MAI



Eurasia Hotel Chiang Mai is an Eden where the air is fresh, and the living is easy. Whether for an overnight, a few days or a long stay, this boutique resort is conveniently located to enjoy all the great stuff Chiang Mai has to offer. Perfect for friends, couples and families on vacation together, there is so much to see and do. Located close to Superhighway road, Eurasia Hotel Chiang Mai is just 10 minutes from all the vibrancy and curiosities of Chiang Mai Night Bazaar. Not to mention Chiang Mai City's extensive shops and malls, restaurants and renowned night life, including a pulsating live music scene. Meanwhile, large living areas in each cottage and Eurasia Suite offer scope to feel at peace, socially interact and share experiences with your fellow travelers. Make good use of the free WiFi internet service to post to your social medias and catch up with the folks back home. Eurasia Chiang Mai Hotel is also an ideal venue for all kinds of meetings, get-togethers and celebrations. Our amenities include two fully-equipped meeting rooms spectacularly situated on our rooftop. The rooms can accommodate 30-80 persons, whether for meetings, seminars, press lunches, executive retreat gatherings and more.

EURASIA

HOTEL | CHIANG MAI



ADDRESS

Eurasia Hotel Chiang Mai
1 Likkasithradvidhee Rd., Nong Pakrang, Muang,
Chiang Mai, 50000, Thailand



www.eurasiachiangmai.com
[/EurasiaHotelChiangMai](https://www.facebook.com/EurasiaHotelChiangMai)
Email: info@eurasiachiangmai.com

Sales Office:
Tel: +66 (0) 5324 7790
Fax: +66 (0) 5324 7797

Reservation Center
Tel: +66 (0) 2 237 7700 # 2561
Mon - Fri 08:30 - 17:00 hrs.
Email: rsvn@imperialhotels.com
www.imperialhotels.com

GDS Code:
Sabre 122463 Galileo 08112 Amadeus CNX762

EURASIA

HOTEL | CHIANG MAI

ACCOMMODATION

| | | |
|-----------------------|--------|----|
| Cottage (Double) | 34 sqm | 6 |
| Cottage (Twin Bed) | 34 sqm | 26 |
| Garden Suite (Double) | 38 sqm | 1 |
| Suite (Double) | 74 sqm | 16 |
| Suite (Twin Bed) | 74 sqm | 16 |

ROOM FEATURES

Air-Conditioning
Bathroom Amenities
Free WiFi
Coffee and Tea Making Facilities
Minibar
Cable TV
2 Complimentary Bottles of Water Daily
Working Desk

HOTEL FACILITIES

| | |
|---------------|-------------------|
| Swimming Pool | 7:00 - 19:00 hrs. |
| Guest Parking | 24 hrs. |
| Garden | 24 hrs. |

GUEST SERVICES

| | |
|--------------------------------|--------------------|
| Airport Transfer | 10:00 - 22:00 hrs. |
| Dry Cleaning & Laundry Service | upon request |
| Room Service | 7:00 - 21:00 hrs. |
| Free WiFi in Public Areas | 24 hrs. |

RESTAURANTS & BARS

| | |
|---------------------------------|-------------------|
| Garden Terrace Restaurant & Bar | 7:00 - 21.00 hrs. |
|---------------------------------|-------------------|

EURASIA

HOTEL | CHIANG MAI



EURASIA SUITE

Live large in a spacious Eurasia Suite measuring 74 sq.m. More than the usual hostel accommodation, every moment in these pristine clean and totally comfortable budget units feels more like living in an exotic Thai boutique resort. With a choice of king size or twin beds, every night will bring you restful sleep. Stretch out in the large living area cooled by the full air-conditioning with in-room control. Switch on the TV and surf the satellite channels for your favorite shows. Hook up to the free WiFi internet and get in touch with your world of friends and family. Relax and soak up the sights and sounds of nature on your large private balcony. Bathe and refresh in the well-appointed bathroom with full amenities, including hot shower, soap and shampoo. Grab a cold drink from the refrigerator, including complimentary drinking water. Or whip up a tea or coffee with the supplies provided for your in-room equipment. And know that whenever you like, Chiang Mai's iconic sites are only a short, pleasant walk away.

ROOM OVERVIEW



2 Adults 2 Kids



King & Twin Bed



74 sq.m



Floor 1-4



Air-conditioned



View



Telephone



LCD TV



Cable/Satellite



High Speed Internet



Safety Box



Sitting Area

AMENITIES



Bathtub



Bathroom Amenities



Hair Dryer



Refrigerator



2 Bottled Water



Kettle



Coffee / Tea Service



Mini-bar



Room Service



Wake-up call Service



Laundry Service



Crib



Extra Bed



Slippers

EURASIA

HOTEL | CHIANG MAI



COTTAGE ROOM

Enjoy all the comforts and conveniences of a spacious cottage set amid a beautiful hostel cum boutique resort. Created in vintage colonial style that goes way beyond the usual hostel concept, every cottage is appointed with full modern amenities and includes your own private terrace where you can sit out and enjoy the garden. Clean and very comfortable, there's everything couples, friends or small families travelling together could wish for to ensure a delightful stay. Choose from twin or king beds with comfortable bedding so you sleep soundly. Blasting away pre-conceptions of budget travel, full amenities include TV with satellite channels, individually controlled air-conditioning, refrigerator with complimentary drinking water, and free WiFi internet.

ROOM OVERVIEW



2 Adults 2 Kids



King & Twin Bed



34 sq.m



Floor 1



Air-conditioned



View



Telephone



LCD TV



Cable/Satellite



High Speed Internet



Safety Box



Sitting Area

AMENITIES



Bathtub



Bathroom Amenities



Hair Dryer



Refrigerator



2 Bottled Water



Kettle



Coffee / Tea Service



Mini-bar



Room Service



Wake-up call Service



Laundry Service



Crib



Extra Bed



Slippers

EURASIA

HOTEL | CHIANG MAI



COTTAGE GARDEN SUITE

Check-into a Garden Suite located in a colonial style cottage and your concept of budget accommodation will never be the same again. Clean and comfortable they certainly are but there's an unmistakable elegance to them, too, not to mention a stylish connection with local arts, design and culture. The essential elements include twin or king beds with fine fabric bedding ensuring a great night's sleep. Adjoined by a living area with armchairs and a table, you are fully facilitated in your life, including free WiFi internet and television with satellite channels. Refresh in the full-function bathroom, including separate shower and bathtub, complimentary toiletries and a hairdryer. Also complimentary is bottled water you can keep in your in-room refrigerator. And your personal safe is there to keep your possessions and documents securely. Sit out on your private terrace in the garden air and reflect that you must have booked into a boutique resort instead.

ROOM OVERVIEW



2 Adults 2 Kids



King Bed



38 sq.m



Floor 1



Air-conditioned



View



Telephone



LCD TV



Cable/Satellite



High Speed Internet



Safety Box



Sitting Area

AMENITIES



Bathtub



Bathroom Amenities



Hair Dryer



Refrigerator



2 Bottled Water



Kettle



Coffee / Tea Service



Mini-bar



Room Service



Wake-up call Service



Laundry Service



Crib



Extra Bed



Slippers

EURASIA

HOTEL | CHIANG MAI

Eurasia Chiang Mai Hotel is an ideal venue for all kinds of meetings, weddings, outdoor poolside events, and school camps. Find out more about our meetings and weddings packages. Or if you prefer something tailored to your own wishes and ideas, we are happy to customize the event especially for you. Our array of amenities includes two fully-equipped meeting rooms. Both The Eurasia 1 and Eurasia 2 are spectacularly situated on our rooftop and can accommodate 30-80 persons comfortably and in style. Full equipment and services are available to support successful meetings, seminars, press lunches, executive retreat gatherings and more. Our outdoor swimming pool area is a perfect choice for private parties.

| Venue | Size | Space (sq.m.) | Classroom | Theatre | I-Shape | T-Shape | U-Shape | Banquet |
|-----------|--------|---------------|-----------|---------|---------|---------|---------|---------|
| Eurasia 1 | 13.5x7 | 95 | 50 | 80 | 40 | 40 | 36 | 80 |
| Eurasia 2 | 13.5x7 | 95 | 50 | 80 | 40 | 40 | 36 | 80 |

EURASIA

HOTEL | CHIANG MAI



EURASIA 1

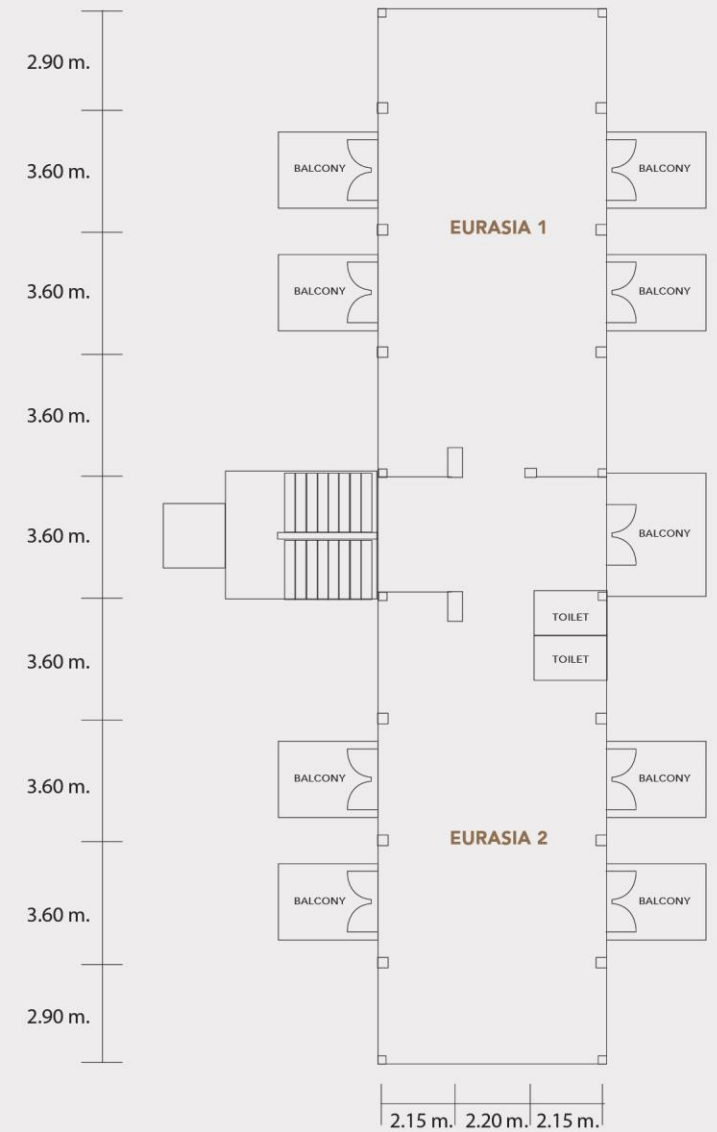

EURASIA

HOTEL | CHIANG MAI



GARDEN TERRACE RESTAURANT & BAR

Our all-day dining restaurant prepares local and international comfort food that you may enjoy from a buffet breakfast or a la carte menu. Clean and casual, it's the perfect location for a sociable meal with your fellow travelers. Whether you like to explore the local cuisine or play safe with something more familiar, each dish is created from fresh ingredients to balance healthiness and deliciousness and served with typical northern Thai grace and warmth.



Thai and International Cuisine



Seating from 130 attendees



Daily 6:00 – 22:30 hrs.



EURASIA

HOTEL | CHIANG MAI



SWIMMING POOL

Our beautiful outdoor swimming pool is the perfect spot to laze in fresh air, cool off during the heat of the day, and loosen up with some not too strenuous exercise in the water.

🕒 Daily 07:00 - 19:00 hrs.

EURASIA

HOTEL | CHIANG MAI



ATTRACTIONS



Wat Phra That Doi Suthep



Waroros Market

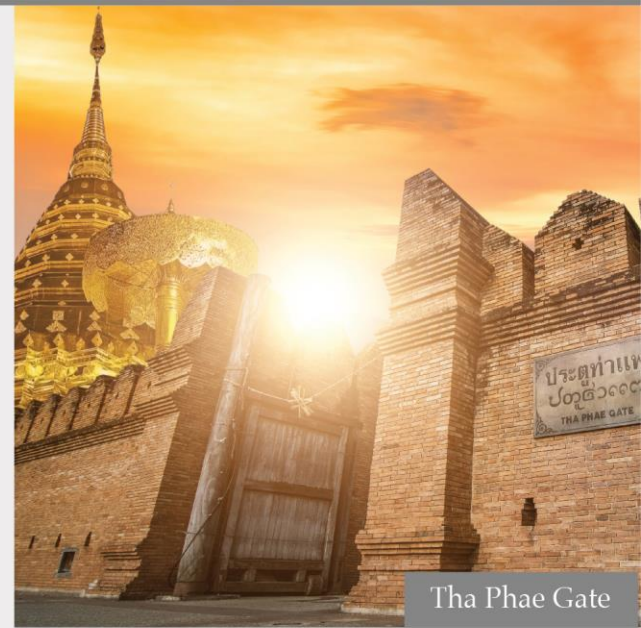

Tha Phae Gate



Wat Phra That Doi Kham



Night Bazaar

| | |
|--------------------------|---------|
| Waroros Market | 3.2 km. |
| Night Bazaar | 3.3 km. |
| Tha Phae Gate | 3.8 km. |
| Wat Phra That Doi Kham | 19 km. |
| Wat Phra That Doi Suthep | 31 km. |

EURASIA

HOTEL | CHIANG MAI