

The  
**IMPERIAL**  
RESORT & SPORTS CLUB | CHIANG MAI

# FACTSHEET



Chiang Mai, Thailand

The  
**IMPERIAL**  
 RESORT & SPORTS CLUB | CHIANG MAI

A delightful venue for private functions, business meeting, group seminars and conferences. Perfect setting for environment-friendly groups and children outdoor activities. Several meeting rooms available, with all vital business support services plus ample space for breakouts in the lavish gardens.

Function Room	SQM.	Capacity (Person)		
		Theatre	Classroom	U Shape
Rachawadee	192	150	100	50
Suchawadee	112	75	50	35
Leelawadee	112	40	30	20



**RACHAWADEE**



**SUCHAWADEE**

# MEETING ROOM FLOOR PLAN

## RACHAWADEE

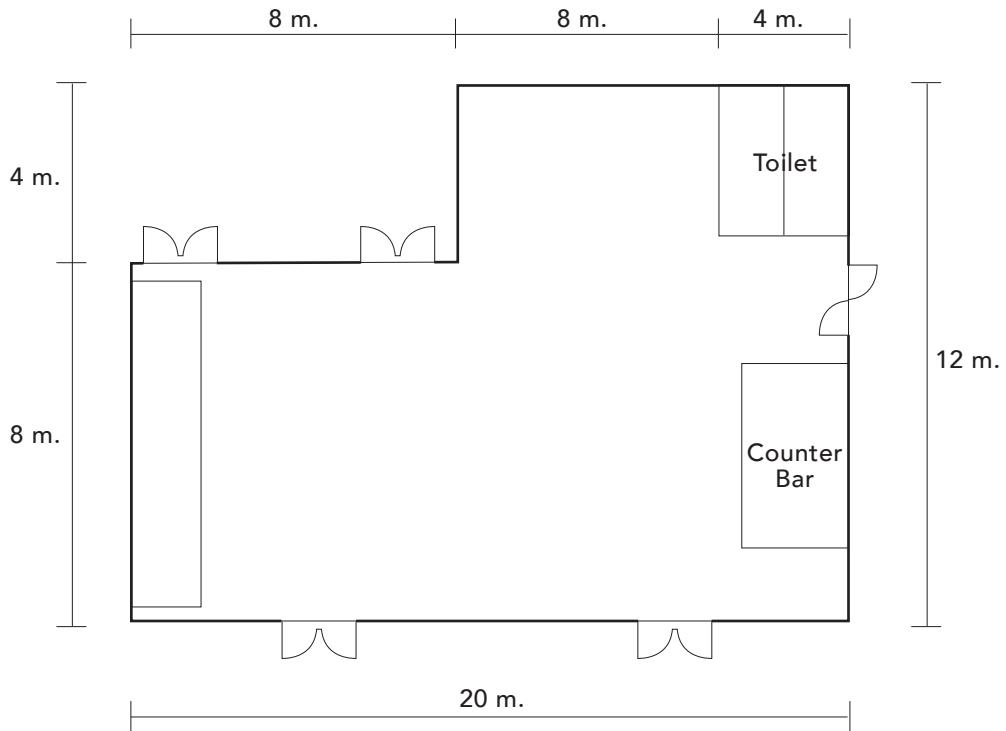

## SUCHAWADEE

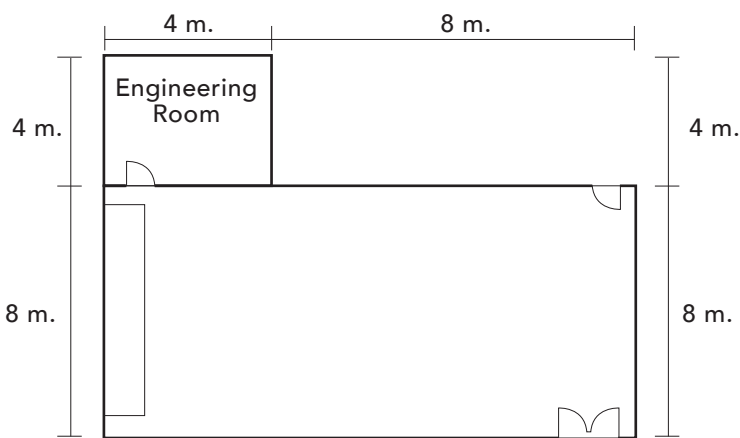

## LEELAWADEE

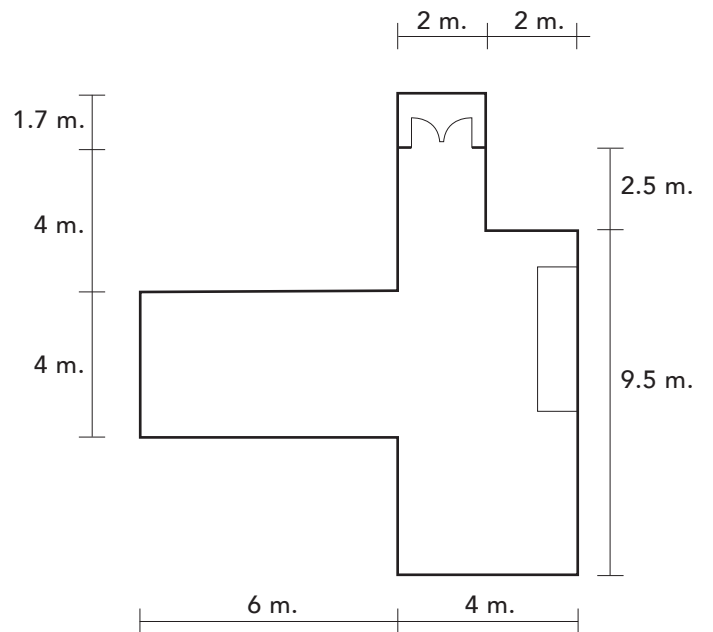



The Imperial Resort & Sports Club Chiang Mai is located in Mae Rim district, the most popular route to tourist attractions such as Elephant Camps, Queen's Botanical Gardens, Soft Adventure & Golf Course, and City Hall. It is a 20-minute drive from Chiang Mai City Centre and Chiang Mai International Airport.

The resort features forty-five Superior Rooms and three two-storey Duplex Suites, with a living room and pantry. Two exclusive Villas are situated by the Ping River, with large gardens perfect for outdoor events up to 1,000 people. All guestrooms, suites, and villa are air-conditioned with a full minibar, TV, and complimentary WiFi.

## ACCOMMODATION

Superior Room	26 sqm	45
Duplex Suite	72 sqm	3
Baan Rim Ping	238 sqm	1

## ROOM FEATURES

- Air-Conditioning
- Bathroom Amenities
- Free WiFi
- Coffee and Tea Making Facilities
- Minibar
- LCD TV
- Hairdryer
- 2 Complimentary Bottles of Water Daily
- Working Desk

## HOTEL FACILITIES

Swimming Pool	7:00 - 20:00 hrs.
Fitness Center	7:00 - 20:00 hrs.
Garden	24 hrs.
Guest Parking	24 hrs.

## GUEST SERVICES

Airport Transfer	upon request
Shuttle Service	upon request
Laundry Service	8:00 - 17:00 hrs.
Room Service	6:30 - 20:30 hrs.
Free WiFi in Public Areas	24 hrs.

## RESTAURANTS & BARS

The Garden View Terrace	6:30 - 21:00 hrs.
Olympic Pool Bar	7:00 - 21:00 hrs.

## ATTRACTIONS

Waroros Market	10 km.
Tha Phae Gate	10 km.
Night Bazaar	11 km.
Wat Phra That Doi Kham	21 km.
Wat Phra That Doi Suthep	31 km.



## ADDRESS

**The Imperial Resort & Sports Club Chiang Mai**  
284 Moo 3, Don Kaew, Chiang Mai-Fang Rd., Mae Rim, Chiang Mai, 50180, Thailand

**Sales Office:**  
Tel: +66 (0) 5312 1650  
Fax: +66 (0) 5312 1646



[www.imperialchiangmai.com](http://www.imperialchiangmai.com)

[/ImperialChiangMai](https://www.facebook.com/ImperialChiangMai)

Email: [info@imperialchiangmai.com](mailto:info@imperialchiangmai.com)

**GDS Code:**

Sabre Galileo Amadeus  
320560 E6238 CNX876

**Reservation Center**  
Tel: +66 (0) 2 237 7700 # 2561  
Mon - Fri 08:30 - 17:00 hrs.  
Email: [rsvn@imperialhotels.com](mailto:rsvn@imperialhotels.com)  
[www.imperialhotels.com](http://www.imperialhotels.com)