

The
IMPERIAL
GOLDEN TRIANGLE RESORT | CHIANG RAI

FACTSHEET



Chiang Rai, Thailand

The
IMPERIAL
 GOLDEN TRIANGLE RESORT | CHIANG RAI

All kind of events and parties can be held easily in the professionally designed meeting facilities. From the intimate room that accommodates from 20 persons until 300 persons.
 The Imperial golden Triangle offers 3 difference locations for function rooms Sipsong Panna meeting room for maximum 50 attendee, Yonok meeting room for maximum 80 attendee and Mekong auditorium for maximum 300 attendee.

Function Room	Sq.m.	Capacity (Person)			
		Theatre	Classroom	Cocktail	Buffet (Round Table)
Sipsong Panna	90	50	40	50	40
Yonok Room	150	80	60	100	60
Maekong Auditorium	300	250	200	300	150



SIPSONG PANNA



YONOK ROOM

MEETING ROOM FLOOR PLAN



MAEKONG AUDITORIUM

SIPSONG PANNA

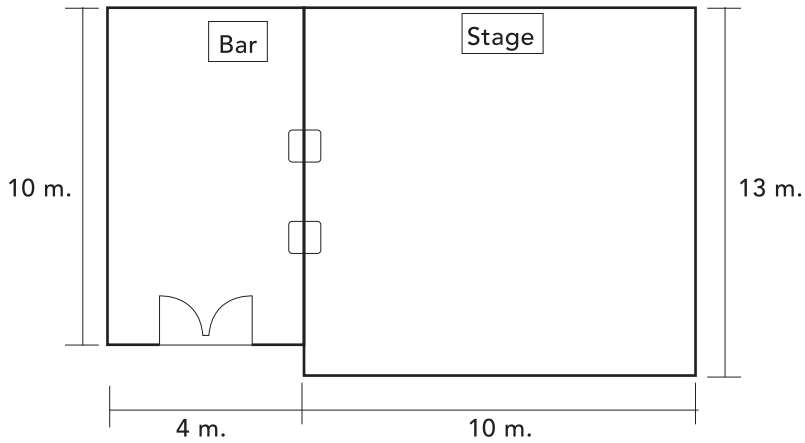

MAEKONG AUDITORIUM

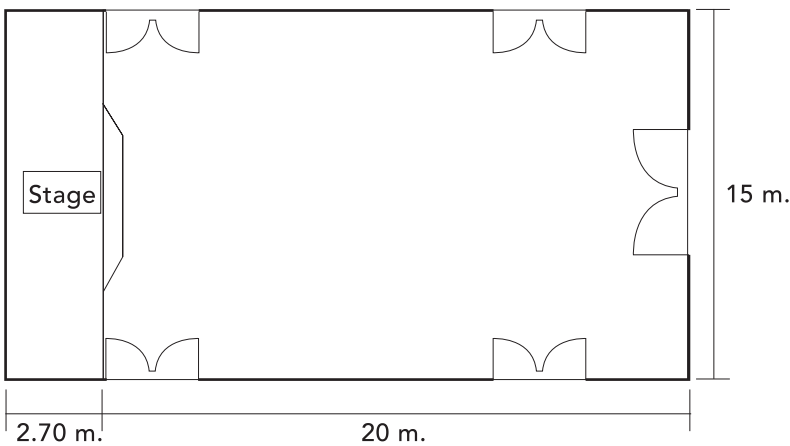

YONOK ROOM

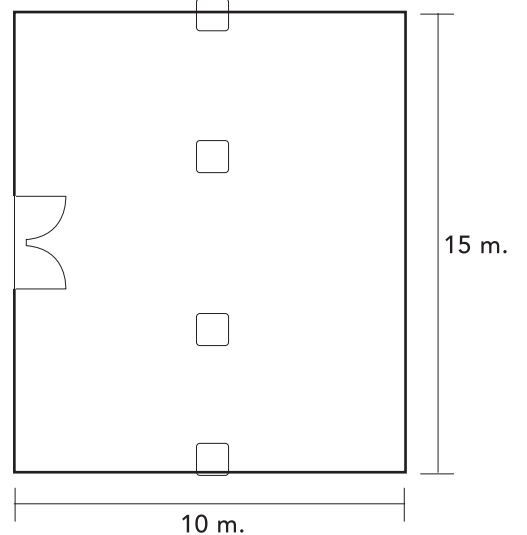



Amidst the majestic Northern mountains, The Imperial Golden Triangle Resort is situated along the borders shared with Laos and Myanmar and where the magnificent Mekong and Ruak Rivers meet. Offering spectacular views of the surrounding landscape, this 73-room property takes in the most that this beautiful region has to offer.

ACCOMMODATION

Superior Room	36 sqm	30
Deluxe Room	36 sqm	15
Deluxe River View	36 sqm	26
Junior Suite Room	72 sqm	1
Presidential Suite	144 sqm	1

ROOM FEATURES

- Air-Conditioning
- Bathroom Amenities
- Free WiFi
- Coffee and Tea Making Facilities
- Minibar
- LED TV
- Hairdryer
- Safety Deposit Box
- 2 Complimentary Bottles of Water Daily
- Working Desk

HOTEL FACILITIES

Swimming Pool	8:00 - 20:00 hrs.
Garden	24 hrs.
Guest Parking	24 hrs.

GUEST SERVICES

Airport Transfer	upon request
Shuttle Service	upon request
Laundry Service	8:00 - 16:00 hrs.
Room Service	6:30 - 22:00 hrs.
Free WiFi Access in Public Areas	24 hrs.

RESTAURANTS & BARS

Border View Restaurant	6:00 - 22:00 hrs.
Pool Bar	10:00 - 20:00 hrs.

ATTRACTIONS

Golden Triangle	0.5 km.
Golden Buddha	0.5 km.
Hall of Opium	1.0 km.
Wat Phathat Jom Kitti	10 km.
Wat Phathat Phangao	13 km.
Sky Walk Phangao	14 km.
Mae Sai Market	29 km.
Doi Tung Royal Villa	60 km.
Choui Fong Tea	70 km.



ADDRESS

The Imperial Golden Triangle Resort
222 Golden Triangle, Chiang Saen, Chiang Rai, 57150, Thailand



 www.imperialgoldentriangleresort.com
 [ImperialGoldenTriangleResort](https://www.facebook.com/ImperialGoldenTriangleResort)
 Email: rsvn@imperialgoldentriangleresort.com

GDS Code:
 Sabre Galileo Amadeus
 320562 E6263 CEI870

Sales Office:
 Tel: +66 (0) 5378 4001 5
 Fax: +66 (0) 5378 4006

Reservation Center
 Tel: +66 (0) 2 237 7700 # 2561
 Mon - Fri 08:30 - 17:00 hrs.
 Email: rsvn@imperialhotels.com
www.imperialhotels.com